

LEADSUN[®]

"Bright Ideas For An Even Brighter Future."



CE | IP65 | IK08



AE3C (Split Type) Solar Street Light

AE3C series split type consists of an off-grid solar system and LED light head separately and satisfies the needs of complicated street lightings. The users can adjust the direction of solar panel and LED light head depends on actual requirements to reach the best energy utilization and lighting effects.



Monocrystalline
Solar Module



Efficient
Controller



LiFePO4 Li-ion
Battery



Motion
Sensor



Superior
Outdoor LED



IP65
Waterproof



5 Years
warranty

Split Design

The AE3C split units can capture the maximum energy by setting the direction of solar engine facing to the strongest solar radiation while the lamp faces to the site you want to illuminate. With split design, users will take the benefit of flexible installation as well as all in one features.



The adjustable bracket can be adjusted from -30° to +90° (each scale is 6 degree).

Solid Product Structure

AE3C adopts modular design with IP65 rated major components and the structural parts are made of high tensile aluminum alloy. Its rational design and high-quality materials make it capable of security, better heat dissipation, waterproof and anti-corrosion to ensure the endurance against harsh environment and prevent from premature failure.

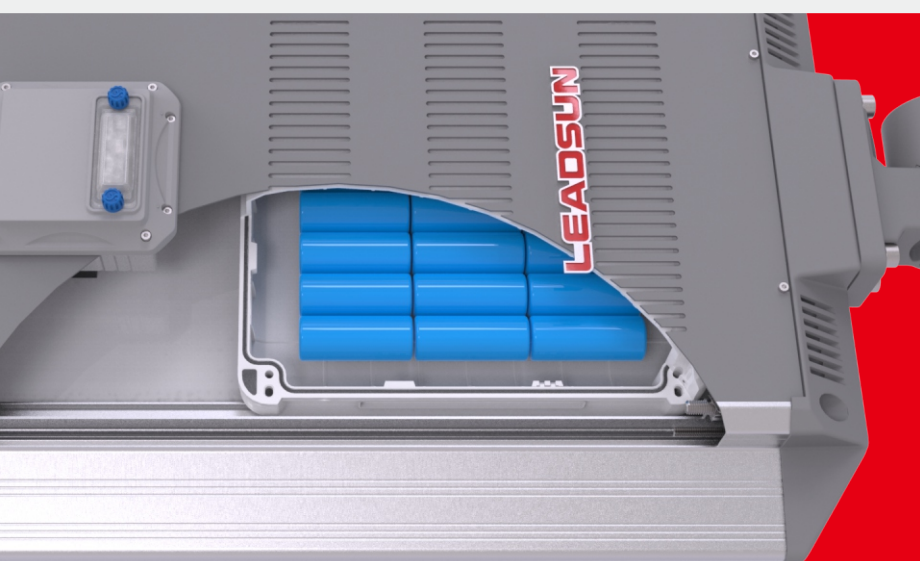
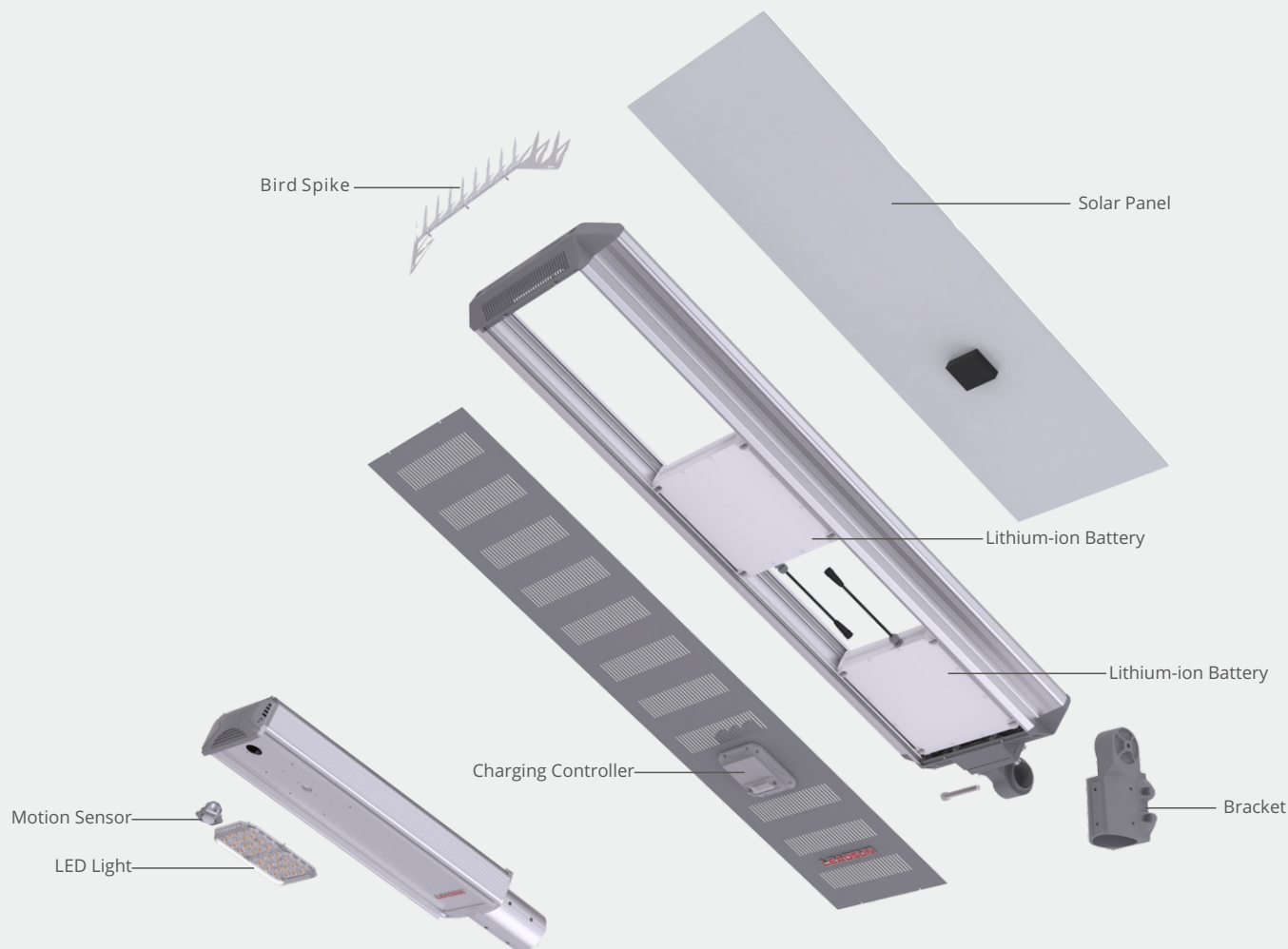

Battery Management System

Adopted environment-friendly LiFePO₄ battery without metal ingredient. The depth of discharge is lifted from 60% up to 90%, 5 times the cycle life.

It combines of the exclusive patented battery management technology, enabling the life span of battery to last for over 8 years.

Intelligent Steady State Controller

With its rich industry experience, Leadsun has independently developed intelligent controllers for solar street lights. AE steady state controller not only realizes the smart control of lighting, but also provides comprehensive protection for the whole system. The controller comes with waterproof programming connector, charging connector and switch, providing the possibility and convenience for later maintenance.

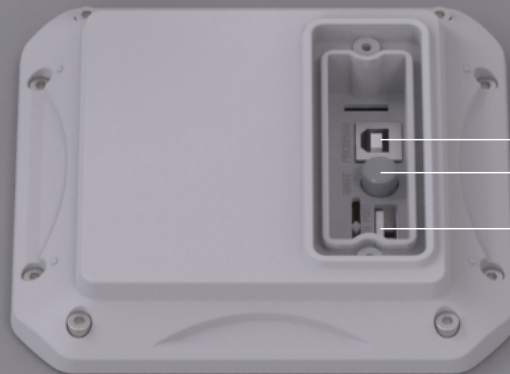

Type B USB
Female Connector
ON/OFF Button
Type A USB
Female Connector

High Efficient LED

Using high-efficiency LED, luminous efficiency is up to 180lm/W (@25 C). The lights sealing lens is made of strong anti-ultraviolet PC, which has anti-aging and anti-impact performance, enabling long term usage.

With the unique cutoff design of the optic lens, allows us to eliminate the lighting pollution to the environment.



Bat Wing Light Distribution

The new lens design improves the lighting effect and lighting uniformity, while also increasing light coverage.

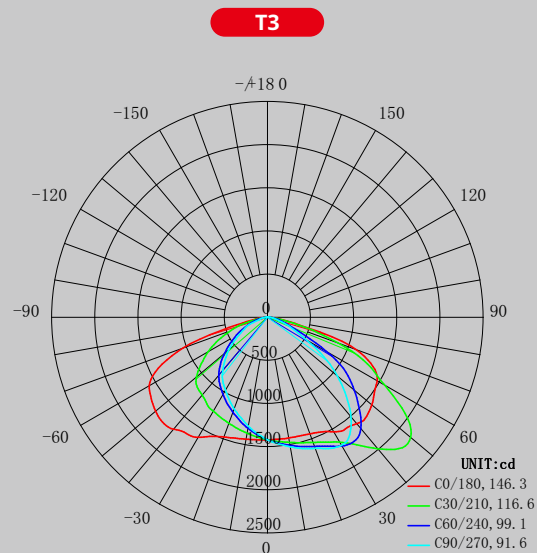
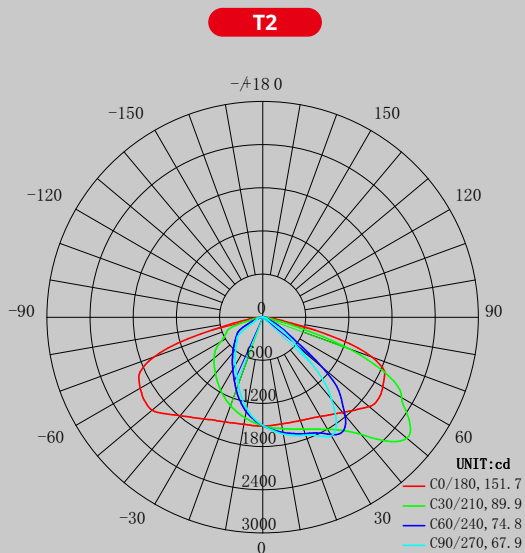

AE3C comes complete with built-in motion detection system that automatically regulate the light source from full bright to dim mode to increase battery autonomy.

100% Brightness when motion is detected

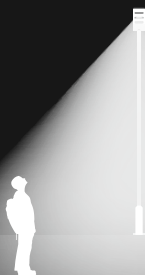

30% Brightness when no motion is detected



Freedom Classic LED Fixture

The newly designed Freedom Classic LED fixture with ultra-sharp **cut-off** optics can significantly reduce lighting glare and eliminates the effects of sky-glow at night. It is offered in a 3000K and fully certified **DARK SKY** compliant fixture for residential development areas that want to minimise light pollution and obtrusive lighting into residential properties.



**Protect night from
light pollution**

**Waterproof and cutoff design
with excellent heat dissipation**

**Using premium outdoor LED
with high luminous efficacy**



IDA Certification requires 3000K CCT or lower
and for fixture to be fixed mount at 90°

LEADSUN

www.leadsglobal.com

Physical Dimensions (mm)

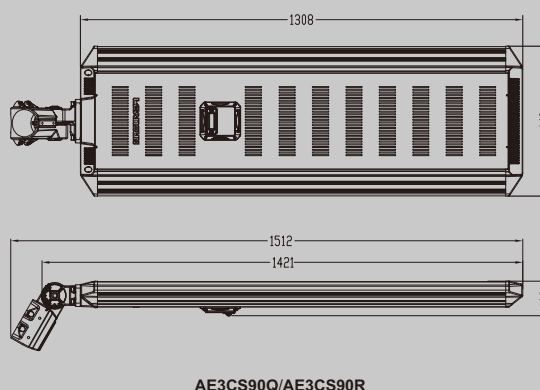
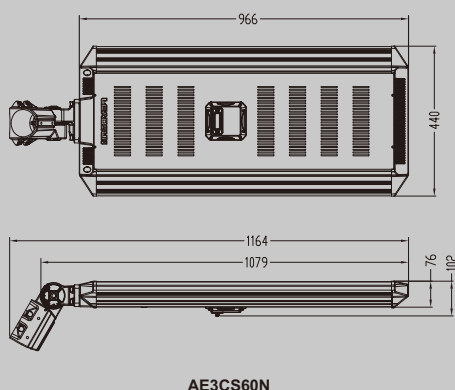

SOLAR ENGINE TECHNICAL DATA

Model No.	AE3CS60N	AE3CS90Q	AE3CS90R
Physical Parameters			
Power of PV Module (W)	60	90	90
Lithium Battery Capacity (Ah/Wh)	308	512	615
Net Weight of Product (kg)	14	19	20
Dimension of Product (mm)	1079(L)×440(W)×102(T)	1421(L)×440(W)×102(T)	1421(L)×440(W)×102(T)
Controller Type	Touch-tone controller	Touch-tone controller	Touch-tone controller
Working Mode	100% brightness when motion is detected, 30% brightness when no motion is detected		
Wireless Control Function (Optional)	/	√	√
Packing Parameters			
Dimension of Carton (mm)×2 Sets	1170(L)×260(W)×510(T)	1510(L)×260(W)×510(T)	1510(L)×260(W)×510(T)
Gross Weight of Product (kg)	32	42	44
Environment Requirement			
Charge Temperature	0°C~51°C	0°C~51°C	0°C~51°C
Discharge Temperature	-20°C~51°C	-20°C~51°C	-20°C~51°C
Storage Temperature (<3 months)	-20°C~45°C	-20°C~45°C	-20°C~45°C
Storage Temperature (3~12 months)	-20°C~25°C	-20°C~25°C	-20°C~25°C
Mounting Recommendation			
EPA (Effective Projected Area) (ft²)	3.05	3.99	3.99
APA (Actual Projected Area) (ft²)	2.54	3.33	3.33
Wind Load Rate (mph)	130	130	130
Top of Pole or Tenon OD (mm)	70~76	70~76	70~76

- * The light source contained in this luminaire shall only be replaced by the manufacturer or his service agent or a similar qualified person.
- * The torque setting for any bolts or screws used to secure the luminaire to the bracket is 14 N/m.
- * Use for outdoors only!

Physical Dimensions (mm)

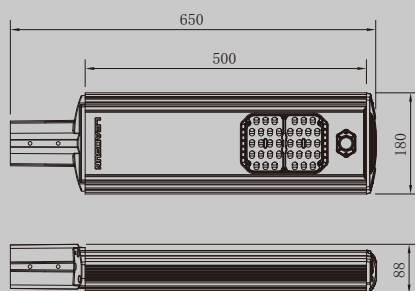

RS12/RS20/RS30/RS40

LED LIGHT HEAD TECHNICAL DATA

Model No.	RS12	RS20	RS30	RS40
Qty. of LED Chips	16	36	36	36
PIR Sensor	√	√	√	√
Maximum Input Power of PV Module (W)	200W	200W	200W	200W
Range of Input Voltage (V)	12V	12V	12V	12V
Storage Temperature	-20°C~45°C	-20°C~45°C	-20°C~45°C	-20°C~45°C
Net Weight (kg)	4.5	4.5	4.5	4.5
Dimension of Product (mm)	650×180×88	650×180×88	650×180×88	650×180×88
Light Parameters				
Light Output (W)	12	20	30	40
Optional Distribution	T2	T2	T2	T2
Visual Angle	140°×70°	140°×70°	140°×70°	140°×70°
Color Temperature (K)	5000K	5000K	5000K	5000K
Typical Luminous Flux (lm)	2220	3800	5550	7200
Packing Parameters				
Dimension of Carton (mm)×2set	680(L)×210(W)×210(T)	680(L)×210(W)×210(T)	680(L)×210(W)×210(T)	680(L)×210(W)×210(T)
Gross Weight of Package (kg)	11	11	11	11
Mounting Recommendation				
EPA (Effective Projected Area) (ft ²)	0.57	0.57	0.57	0.57
APA (Actual Projected Area) (ft ²)	0.47	0.47	0.47	0.47
Wind Load Rate (mph)	130	130	130	130
Installation Height (m)	3~5	4~7	5~8	5~8
Installation Distance (m)	12-20	15-25	20~30	20~30
Recommended Diameter of arm (mm)	60	60	60	60

- * The light source contained in this luminaire shall only be replaced by the manufacturer or his service agent or a similar qualified person.
- * The torque setting for any bolts or screws used to secure the luminaire to the bracket is 14 N/m.
- * Use for outdoors only!